

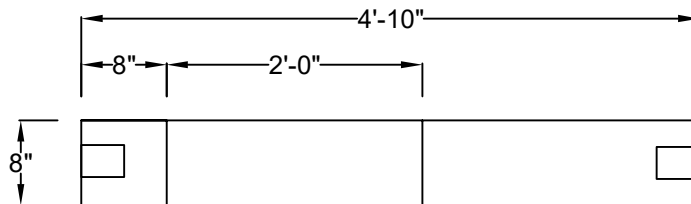

# Precast Concrete 48" Dia. Flat Top With No Lip

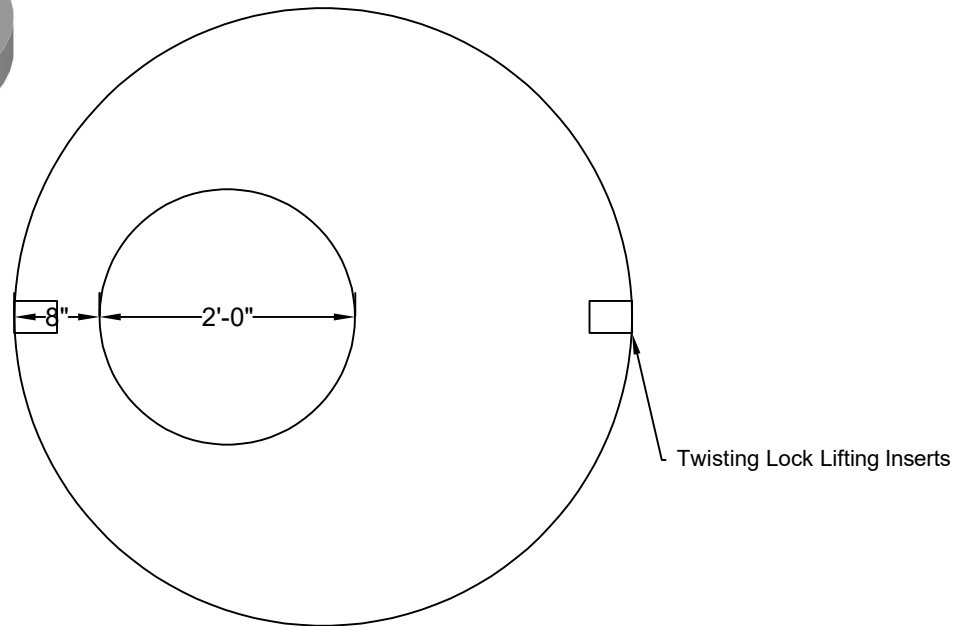

Weight: 1,500 lbs

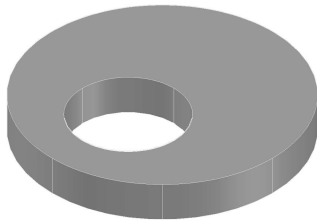

## Standard Features

- 4500 PSI Concrete @ 28 Days
- Conforms to ASTM C-478
- Design for H2O Traffic Loading
- Manufactured in NPCA Certified Plant



T: 269-342-0539  
F: 269-344-4810  
qualityprecastinc.com

7800 ADOBE RD.  
KALAMAZOO, MI