

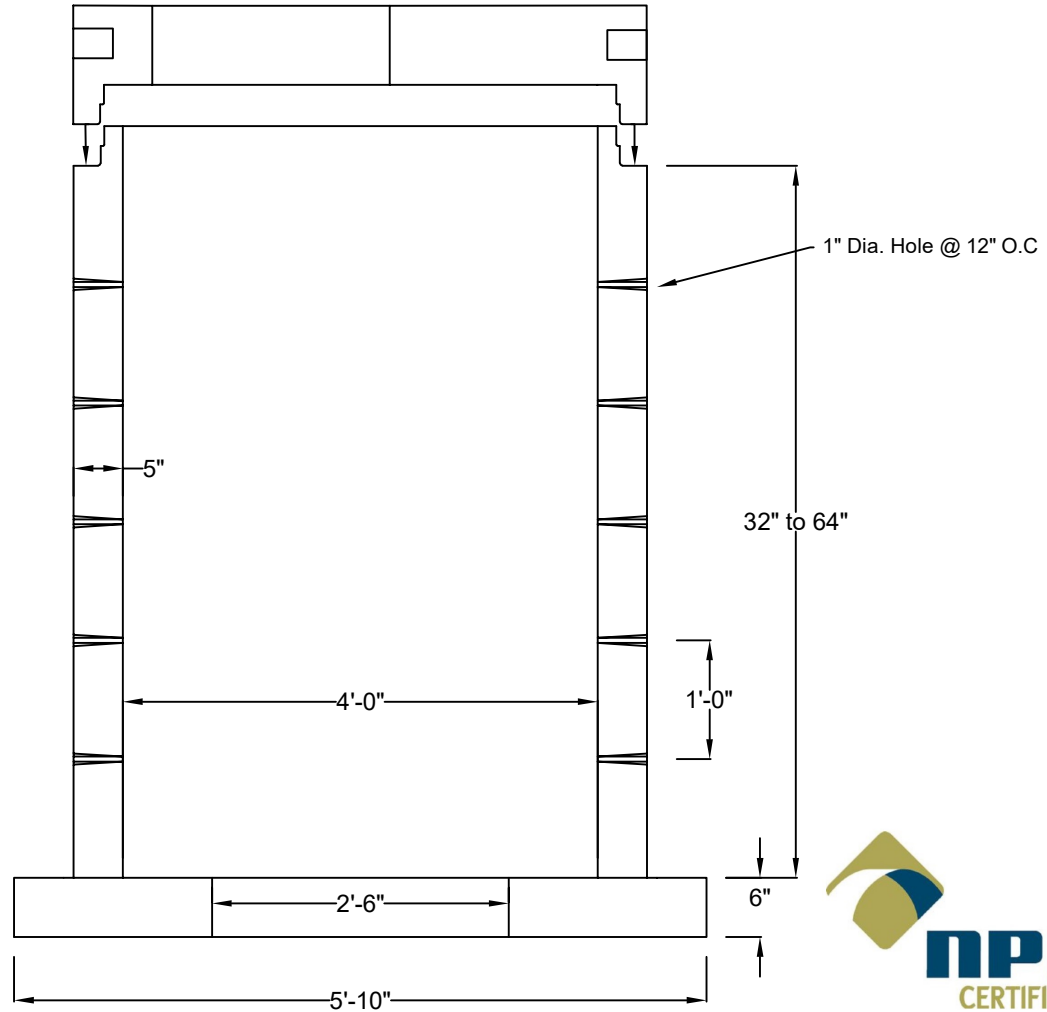

Precast Concrete 48" Dia. Leeching Manhole

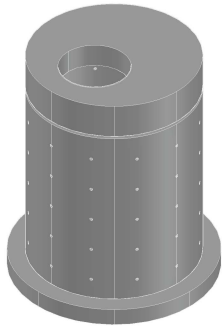

Standard Features

- 4500 PSI Concrete @ 28 Days
- Conforms to ASTM C-478
- Design for H2O Traffic Loading
- Manufactured in NPCA Certified Plant

Standard Options

- Cast Iron Frame and Cover
- 24" or 36" Eccentric Cone Top
- 1", 2", 3" Precast Adjustment Rings
- Pipe Inlet/Outlet Holes Where Specified



T: 269-342-0539
 F: 269-344-4810
qualityprecastinc.com

7800 ADOBE RD.
 KALAMAZOO, MI