

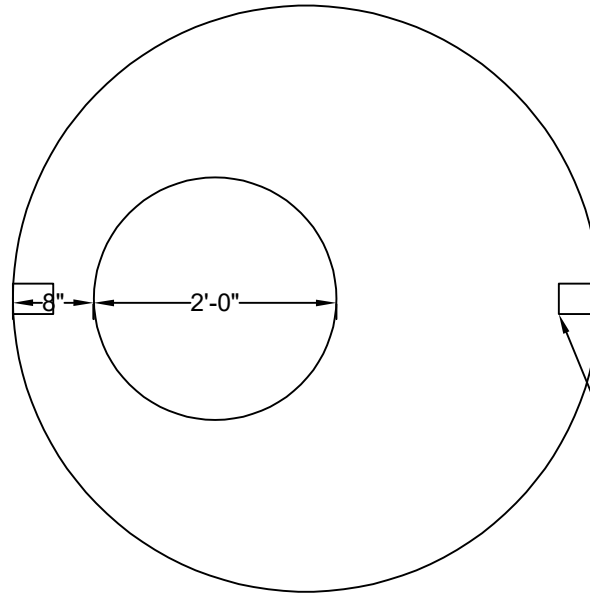

Precast Concrete 48" Dia. Flat Top With Lip

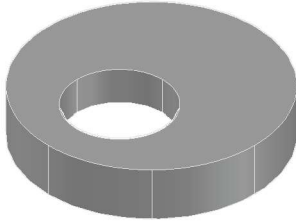

Twist Lock Lifting Inserts

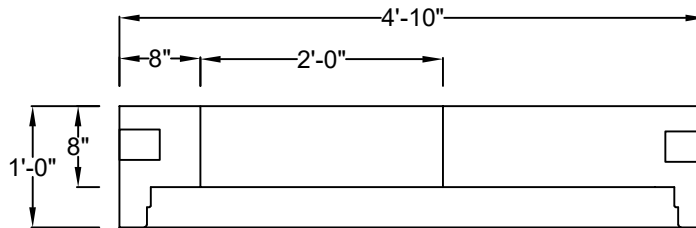

Weights: 1,500 lbs

Standard Features

- 4500 PSI Concrete @ 28 Days
- Conforms to ASTM C-478
- Design for H2O Traffic Loading
- Manufactured in NPCA Certified Plant

Standard Options

- Gasket Joint



T: 269-342-0539
F: 269-344-4810
qualityprecastinc.com

7800 ADOBE RD.
KALAMAZOO, MI